KIT PART NUMBER 4320027
INSTRUCTIONS FOR INSTALLING HIGH SECURITY DOOR STOP KIT
IN 432 AND 962 MACHINES.

CHECK THE PARTS RECEIVED IN THIS KIT WITH THE PARTS LIST IN THESE INSTRUCTIONS. IF ANY PARTS ARE MISSING CONTACT THE CRANE MERCHANDISING SYSTEMS' PARTS DEPARTMENT AT 1-800-621-7278.

Read these instructions carefully before installing the kit.
Keep these instructions for part numbers and for future reference.

THIS KIT CONTAINS THE FOLLOWING:

PART NUMBER	DESCRIPTION	QTY
4322320	BRKT-VEND DOOR-HI SECURITY	9
4320026	INST-KIT-HI SECURITY (THIS DOCUMENT)	1
AP201-6R7	#6X7/16 PH RD HD TYPE B ZN/WAX	8
4321168	SCREW-#6-19 X .31 PHIL.PHS.T/C	18

1. Read these instructions carefully before installing this kit.
2. Turn the machine OFF with the main switch. Failure to do so could result in personal injury.
3. Remove existing door stop. Figure 1

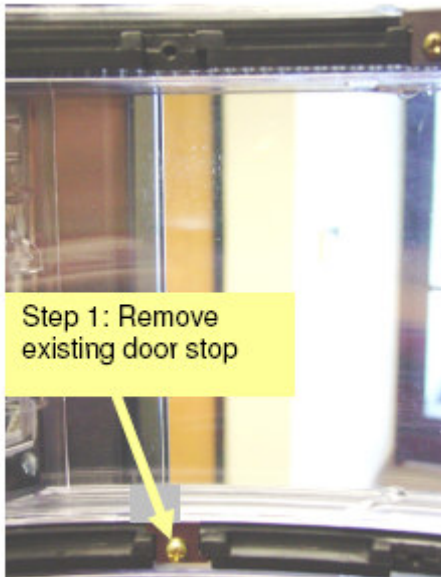

Figure 1

4. Install new security bracket (figure2) with the shorter flange at the top (figure3).

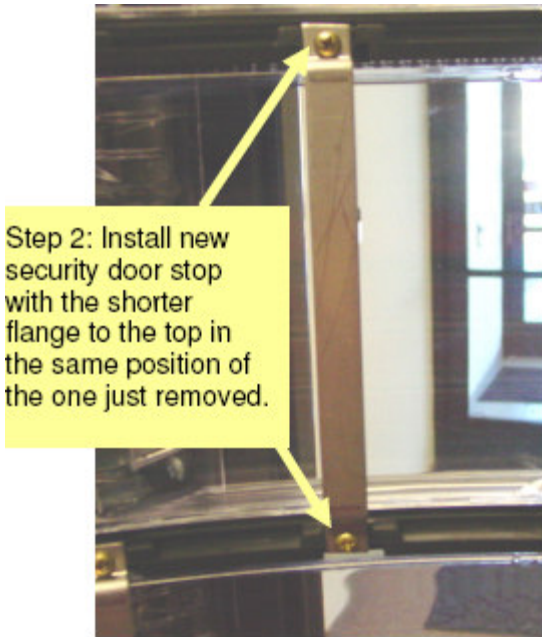
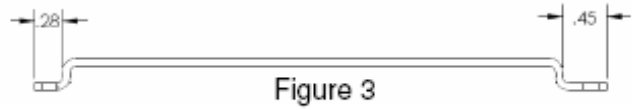

Figure 2



IMPORTANT NOTE! If 2 or more security brackets need to be attached in line with one another as shown in figure 4 only use the long silver screws where the flanges overlap. Use the gold screws for single flap attachment.

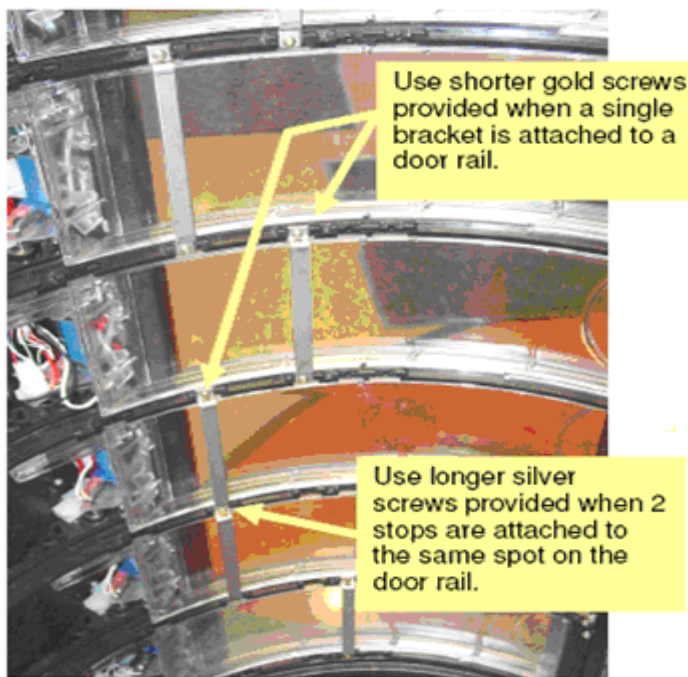

Figure 4

5. Repeat steps 1 and 2 for all 9 doors.
6. Test all doors for proper operation and adjust stops if necessary.